

FAÇADES

WOOD-BASED
MATERIAL SOLUTIONS
BY PFLEIDERER



MADE IN GERMANY

MAKE
YOUR
VISIONS
WORK.
NATURALLY
SUSTAINABLE

DUROPAL

thermopal

 PFLEIDERER

**MAKE
YOUR
VISIONS
WORK.**

**NATURALLY
SUSTAINABLE**

WOOD-BASED PANELS THAT OPEN UP NEW PERSPECTIVES.

From design to completed projects, every step counts. After all, designs are only really appealing if they can be achieved. By choosing Pfleiderer, you're off to the right start. Aesthetic, functional and the perfect design solution. Stylish, expressive and modern decors, innovative surface textures and core panels all come together perfectly to meet your technical, cost and user requirements. From high quality individual items to sector spanning concepts – you can turn your vision into reality with practical, high quality solutions from Pfleiderer.



Learn more about our façade solutions online at pfleiderer.com/facade-panels

ADVANTAGES OF PFLEIDERER FAÇADE PANELS 4

Permanent protection	6
Unique design variety	10
Low maintenance requirements	20
Systematic resource conservation	24

REAR-VENTILATED CURTAIN FAÇADE AT A GLANCE 28

FAÇADE CONFIGURATOR 30

EXAMPLES OF FAÇADE DESIGN

Detached house	32
Multi-storey residential building	34
Accommodation and food service	36
Office and education	38
Industrial building	40
Balconies and parapets	42

REFERENCES 44

INSTALLATION 46

PRODUCT INFORMATION 48

QUALITY 52

SUSTAINABILITY 54

ADVICE & SERVICES 56

**NOT JUST A
SURFACE**

**ROBUST
AESTHETIC**

**COMPACT FAÇADE PANELS:
FOR PERFECT REAR-VENTILATED
CURTAIN FAÇADES!**

The quality of a façade is a result of the interplay of the façade system and the material. Due to the structural separation of the outer layer, the insulation and the rear-ventilation space, a rear-ventilated curtain façade achieves physical advantages that are optimally supplemented by Duropal XTerior compact façade panels. Good moisture protection, sound insulation and a high energy efficiency all combined with a unique selection of decors and colours suitable for a long service life. The complete system is also easy to dismantle, individual panels can be replaced without difficulty when necessary. The result is façade solutions that impress right down the line in terms of their aesthetics and function.

**LOW-MAINTENANCE
SUSTAINABILITY**



ROBUST

NATURALLY ROBUST: PROTECTION THAT IS PLAIN TO SEE.

The façade is the most important protective casing that a building has against all external influences. The more reliably it protects the building from moisture, sunlight and physical impact, the better. Pfeleiderer façade panels consist of highly robust high-pressure laminate with a homogeneously coloured core and a single- or double-sided weather-resistant functional layer. In addition, a rear-ventilated curtain façade supports a permeable façade structure and thus the transfer of the moisture to the outside.

PERFECTLY EQUIPPED TO DEFY THE ELEMENTS

First choice from the point of view of the building physics

A rear-ventilated curtain façade – combined with the right façade material – offers a number of advantages. It provides optimal moisture protection by allowing rain, hail or snow to simply roll off it, without inhibiting the natural air circulation on the surface of the building. Almost any desired heat insulation can be integrated into its multi-layered structure, contributing to a good energy efficiency of the building. When compact panels such as Duropal XTerior compact are used, their density and composition means that the noise generated by driving rain is low in comparison with other materials, e.g. metal.

Also with fire safety properties

In the form of Duropal XTerior compact F, there is also an 8 mm-thick flame-retardant variant, which has the fire rating B-s1, d0 in accordance with EN13501-1 and is particularly suitable for use in façades up to building class 5 in the public sphere.

UV protection built in

The sun is a cause of wear for façade materials that should not be underestimated. Therefore, it is good to know that Duropal XTerior compact is extremely UV-resistant. This applies both to the integrity of the material itself and to the colour fastness of the decors. This ensures that both the building physics and the visual appearance permanently meet the requirements that are placed upon them.





AESTHETIC

SOPHISTICATED EYE-CATCHER: FAÇADE PANELS WITH DESIGN FREEDOM.

Harmonious, rich in contrast or accented. With a uniquely wide-ranging selection of decors, Duropal XTerior compact provides almost unlimited freedom of design. The material is available in stylistically confident plain colours and realistic wood and stone decors. Duropal XTerior compact is also equipped with the matt surface texture Exterior Matt. With its velvety finish, it creates an extremely high-quality look that makes façades into fascinating eye-catchers from any angle and in all weathers!

STYLISTICALLY CONFIDENT AND QUICKLY REALISED. FOR IDEAS THAT INSPIRE.

A wide selection of stock and decor options are available on request via your Pfleiderer Façade Supplier

Duropol XTerior Compact is available at short notice in numerous, stylish plain colours as well as in high-quality stone, wood and metal decors. This ensures that design ideas can be quickly and reliably implemented.



U16051 Siena Red **EM** **U18029** Horizon **EM** **U18505** Lagoon **EM** **U19015** Spearmint **EM** **U16058** Be rooted! **EM**



U18004 Dark Blue **EM** **U18074** Atlantic **EM** **U18501** Fjord **EM** **U19007** Agave **EM** **U11102** Chalk **EM**



U12044 Dolphin Grey **EM** **U12188** Light Grey **EM** **U12115** Platinum Grey **EM** **U12215** Anthracite **EM** **U12000** Volcanic Black **EM**

PRODUCT VARIANTS

Product	Format	Surface texture	Reaction to fire
Duropol XTerior compact	2,800 x 2,070 x 6 mm	EM/VV	normally flammable
Duropol XTerior compact	2,800 x 2,070 x 8 mm	EM/EM	normally flammable
Duropol XTerior compact	2,800 x 2,070 x 13 mm	EM/EM	normally flammable
Duropol XTerior compact F	2,800 x 2,070 x 8 mm	EM/MP	flame retardant



W10410 Opaque White **EM**



R55072 Willow White **EM** **R20095** Milano Oak **EM** **R20038** Natural Chalet Oak **EM** **R20027** Pale Lancelot Oak **EM** **R34015** Ladoga Ash Dark **EM** **R50084** Golden Teak **EM** **R38000** Chestnut **EM**



R55004 Ponderosa Pine **EM** **R20351** Flamed Wood **EM**



S60036 Classic Concrete **EM** **F76037** Phoenix Brown **EM**



F76115 Metex Steel **EM** **F76146** Terrazzo Bronze **EM**



F76006 Tempered Steel **EM**

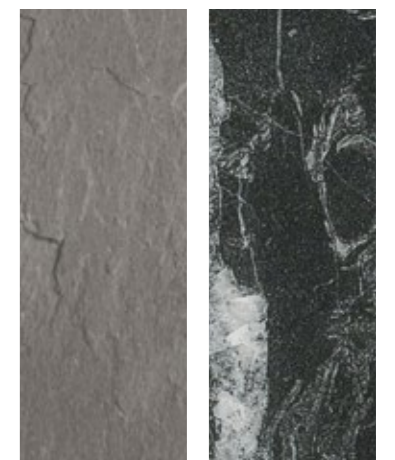

S64011 Deep Slate **EM** **S63028** Nero Portoro **EM**

COMPLETE SELECTION: DRAWING FROM UNLIMITED AESTHETIC RESOURCES.

Uniquely varied

Duropol XTerior compact brings unlimited design possibilities to façade design. Numerous decors from the full collection can be delivered. In this way, Pfleiderer provides the optimal basis for the precise realisation of colour concepts – from a harmonious overall design to individual contrasting highlights and the showcasing of materiality, through to the accentuation of the structure of parts of buildings or ensembles.

COMPLETE COLLECTION

Product	Format	Surface texture	Reaction to fire
Duropol XTerior compact F	2,800 x 2,070 x 8/10/12/13 mm	EM/MP	flame retardant
Duropol XTerior compact	2,800 x 2,070 x 6/8/10/12/13 mm	EM/VV, EM/EM	normally flammable

Fascinating, matt surfaces

The surface texture Exterior Matt (EM) gives Duropol XTerior compact/Duropol XTerior compact F a particularly attractive look. The delicate grain gives the surface a velvety appearance and yet still reflects the light. The resulting shimmer has a high-quality effect and harmoniously enhances the decor and shape at any angle of light incidence. Exterior Matt also delights people with its a low-maintenance finish whose appearance leaves an excellent impression even after many years.



You can find the complete Duropol XTerior compact collection online in the decor finder at pfleiderer.com/decor-finder

DUROPAL XTERIOR COMPACT / DUROPAL XTERIOR COMPACT F COLLECTION



DUROPAL XTERIOR COMPACT / DUROPAL XTERIOR COMPACT F COLLECTION

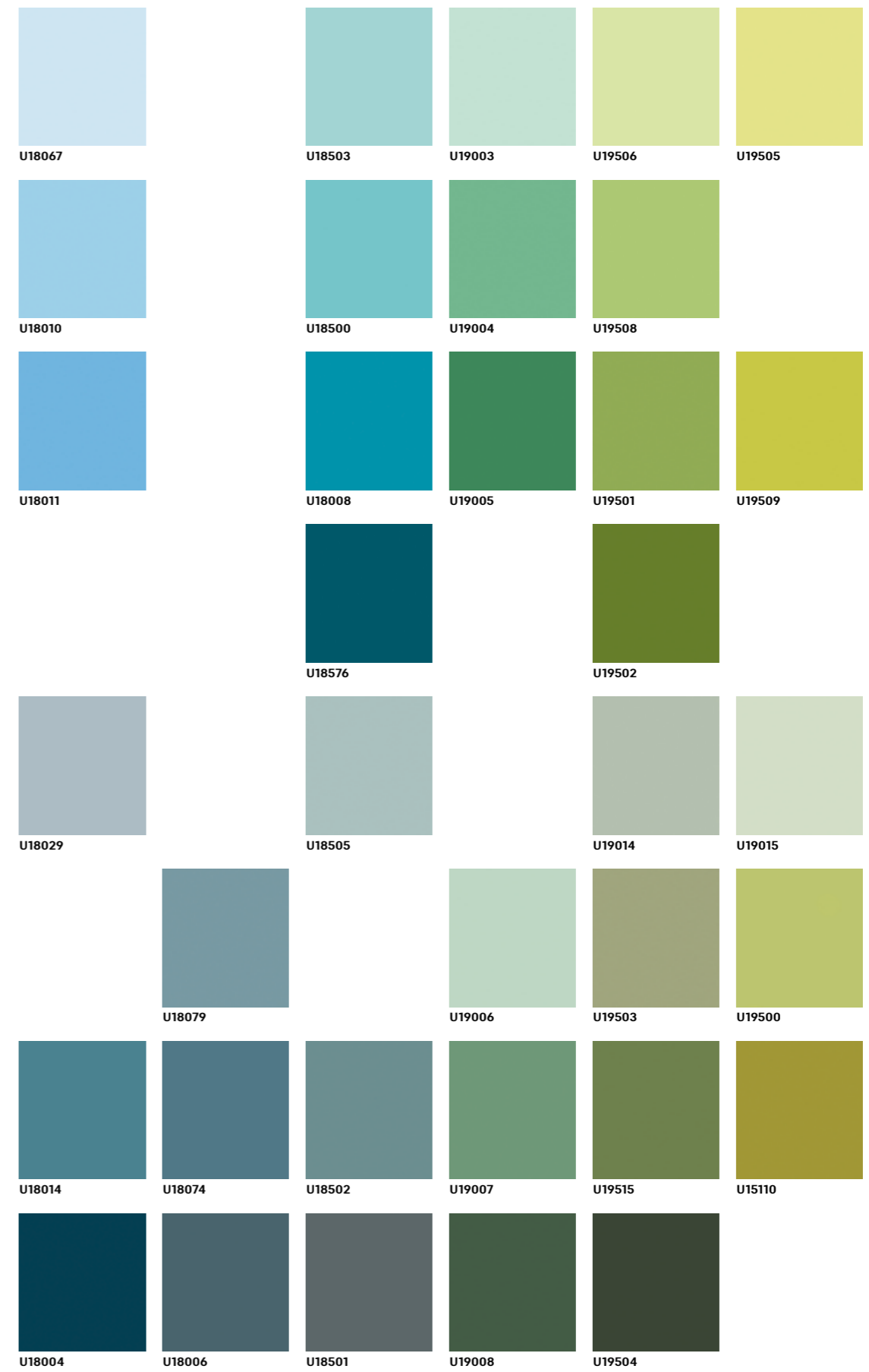

DUROPAL XTERIOR COMPACT / DUROPAL XTERIOR COMPACT F COLLECTION

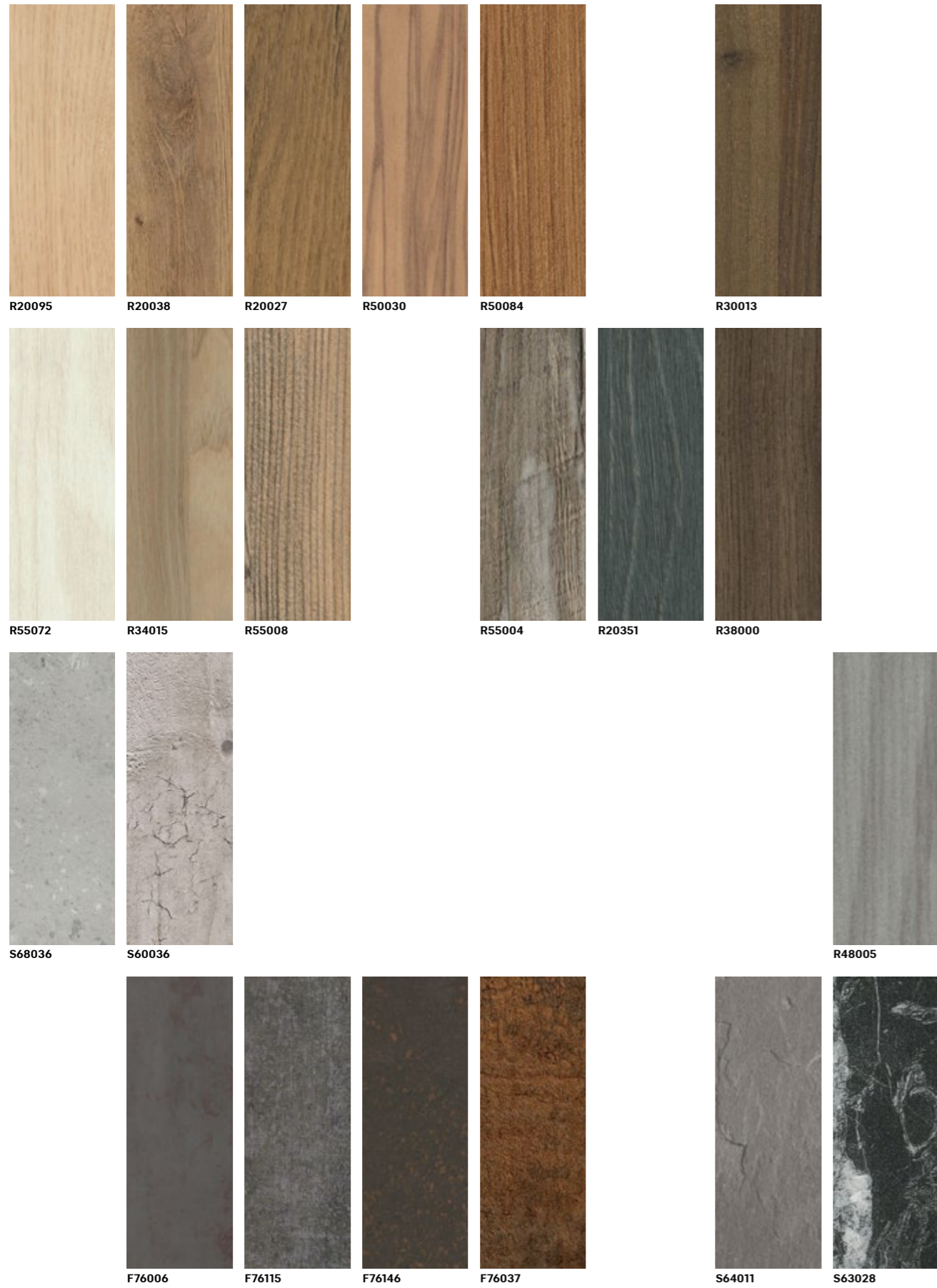



LOW-MAINTENANCE

TIMELESSLY ATTRACTIVE: THE PERFECT MATERIAL FOR FAÇADE

The façade plays a decisive role in shaping people's first impression of a building. Whether it always presents itself in the best light is a question of the right material. Pfleiderer façade panels provide the best conditions for this. Thanks to their functional surface, it is easy to remove graffiti.

SIMPLY WELL THOUGHT OUT: ATTRACTIVE FAÇADE, EASY TO CARE FOR.

Low-maintenance surface

Pfleiderer façade panels have a surface on which impurities are hardly able to take hold. It can be cleaned reliably and quickly. Especially in the case of public buildings, in an urban environment and where there is intensive use, the appearance of façades is jeopardised by vandalism and wear, amongst other things. Thanks to the special surface technology, impurities or graffiti can be removed from the Duropal XTerior compact façade panel without residue.





SUSTAINABILITY

SMART BUILDING: CONSERVING RESOURCES WITH FAÇADES.

Nowadays, sustainability plays an important role in every construction project. Rear-ventilated curtain façades with the Duropal XTerior compact façade panel can make a decisive contribution towards reducing the environmental footprint and making buildings more resource-efficient.

FUTURE-PROOF AND LONG LASTING WITH RECYCLING IN MIND.

The first choice in perpetuity

The timeless design possibilities and the low-maintenance finish of Pflaiderer façade panels improves the economic efficiency and sustainability. As Duropal XTerior compact panels never go out of fashion and lose none of their attractiveness, they do not require replacement or post-treatment even after years.

Fully recyclable and dismantlable

Thanks to comprehensive material concepts and product life cycle models, Pflaiderer façade panels can be given full consideration with respect to their reusability in sustainability concepts in the context of building planning. At the end of the primary period of use or in the event of renovations, they can be dismantled with little effort and sorted by material. Thermal recycling is also possible.



PROTECTION AND BEAUTY IN PERFECT UNISON

SYSTEMATICALLY BETTER: REAR-VENTILATED CURTAIN FAÇADES.

The rear-ventilated curtain façade sets standards for intelligent, sustainable construction. With Duropal XTerior compact / Duropal XTerior compact F as the building envelope, a façade system is created with advantages that impress all down the line:

- **Weather-resistant:** excellent protection against weather conditions such as rain, snow and wind
- **Robust:** very durable, low-maintenance
- **Cost-effective:** due to the high durability of the façade, low maintenance costs and a potentially high degree of prefabrication
- **Energy-efficient:** rear-ventilation space and high insulation cross-sections provide powerful advantages in terms of the building physics
- **Decorative variety:** the large variety of decors in the Pfleiderer Duropal XTerior compact / Duropal XTerior compact F collection makes a colour match between the façade and the interior design product possible.

The structure in detail: rear-ventilated curtain façade, with installation space, formwork

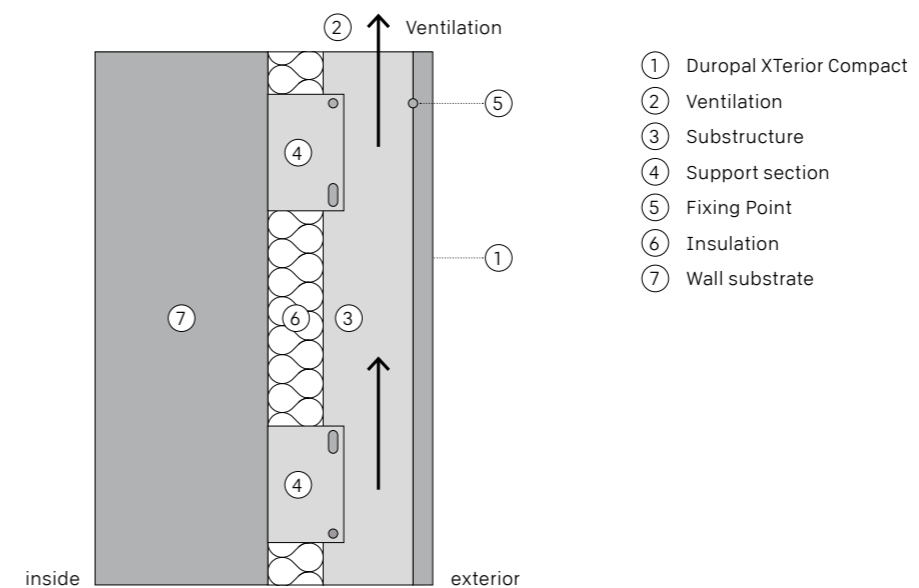

IMPRESSIVELY VIVID: THE PFLEIDERER FAÇADE CONFIGURATOR

The Pfleiderer façade configurator is available for exploring the design options with Duropal XTerior compact façade panels. Here you can rework different types of buildings according to your individual requirements in just a few clicks – from the selection of the decor to the panel size and arrangement, through to the fixing method. Perfect for visualising ideas and preparing advisory and tender documents.



Discover all the possibilities now – with the Pfleiderer façade configurator. Simply try it out online: pfleiderer.com/facade-configurator

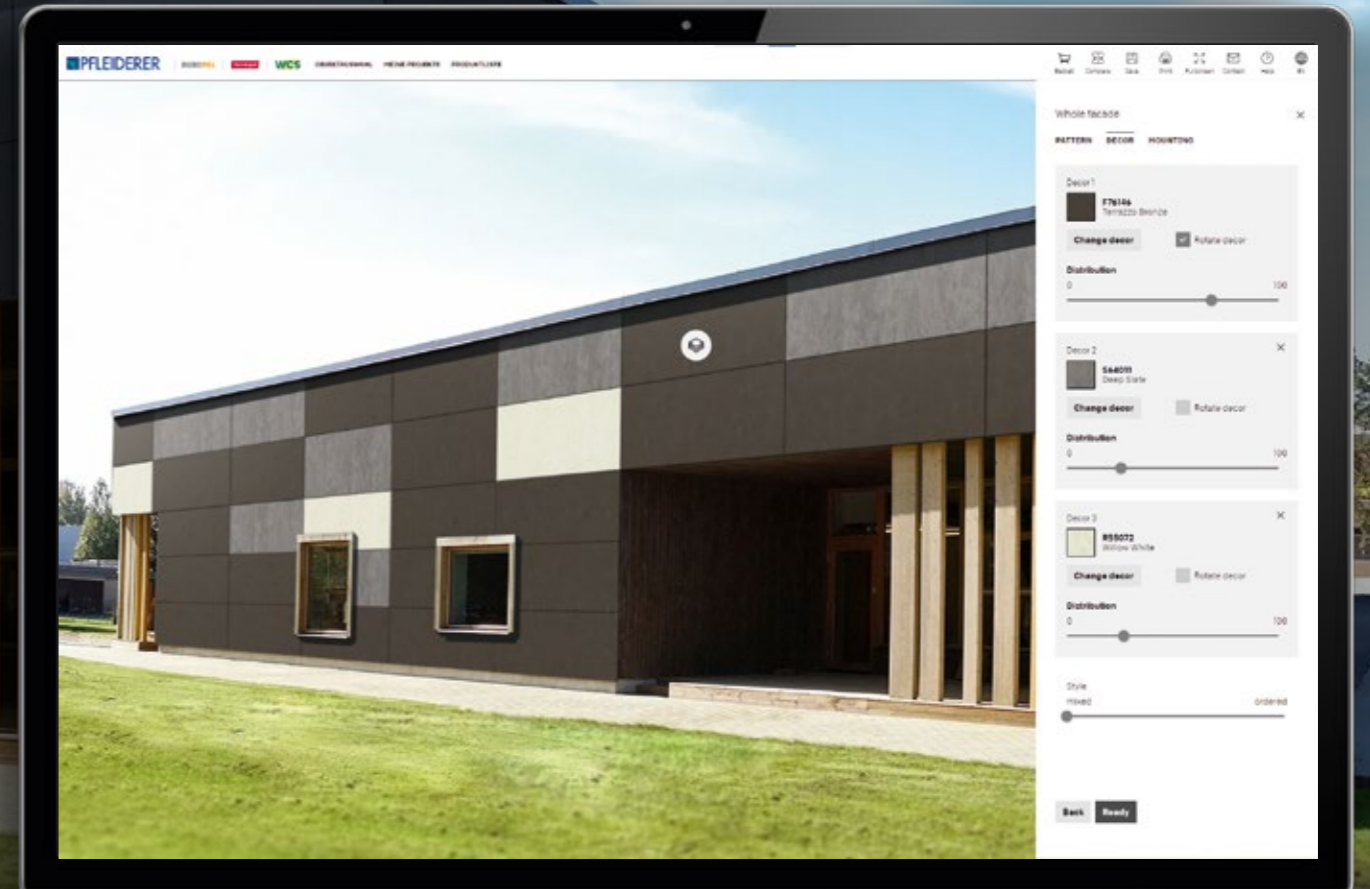

Detached house



Multi-storey residential building



Accommodation and food service



Office and education



Industrial building



Balconies and parapets

You can find further examples of the use of Pfleiderer panels for the façade design of different types of buildings on the following pages.

DETACHED HOUSE

CUSTOMISED MEETS PRACTICAL: A HOME WITH PERSONALITY.

Whether they are installed when the building is first built or as part of a modernisation, Duropol XTerior compact façade panels give your home just the appearance that homeowners want. Thanks to the uniquely wide range of plain decors, colour concepts can be realised accurately and also combined with wood or stone decors on request. As a rear-ventilated façade, the Pfleiderer façade panels can also score points with a long service life with low maintenance requirements.



Discover all the possibilities now –
with the Pfleiderer façade configurator.
Simply try it out online:
pfleiderer.com/facade-configurator

MULTI-STOREY RESIDENTIAL BUILDING

SMARTER LIVING: FAÇADE SYSTEMS WITH ADDED VALUE.

In multi-storey residential buildings, economic efficiency and building physics are gaining in significance alongside with visual appearance. It is important to reconcile insulating properties, weather protection and fire safety properties with ease of handling, durability and quality of life. Duropal XTerior compact F as part of a rear-ventilated curtain façade is perfect for this.



Discover all the possibilities now –
with the Pfleiderer façade configurator.
Simply try it out online:
pfleiderer.com/facade-configurator

ACCOMMO- DATION AND FOOD SERVICE

STYLISTICALLY CONFIDENT CONCEPTS FOR CONSTRUCTED HOSPITALITY.

Restaurants and hotels also want to delight their guests visually. It is not only important that the external appearance is aesthetically right. The durability and the associated economic factors must be taken into consideration. Thanks to its dirt-resistant and low-maintenance surface, Duropol XTerior compact panels give an unmistakably distinguished look for the long term!



Discover all the possibilities now –
with the Pfleiderer façade configurator.
Simply try it out online:
pfleiderer.com/facade-configurator

OFFICE AND EDUCATION

LEAVES AN IMPRESSION: CONCEPTS FOR AN INVITING ENVIRONMENT.

Educational institutions and places of work are highly frequented places where people spend a lot of time. Therefore, they should not only be functionally appealing, but should also express appreciation through their aesthetics – ideally right from the long-distance effect of the façade. Duropal XTerior compact panels ensure that buildings such as offices, schools or nurseries stand out visually and remain attractive even after intensive daily use for years.



Discover all the possibilities now –
with the Pfleiderer façade configurator.
Simply try it out online:
pfleiderer.com/facade-configurator

INDUSTRIAL BUILDING

PROTECTS VALUES. AND CREATES IDENTITY.

In commercial and industrial buildings, the focus is on functionality and economic efficiency. For many companies, buildings are an expression of the organisations own identity. Pfeiderer façade panels are perfect for this as they can be mounted on a variety of substructures, such as aluminium, steel or wood, and provide high-quality protection and an accurate realisation of design guidelines with their wide range of decors.



Discover all the possibilities now –
with the Pfeiderer façade configurator.
Simply try it out online:
pfeiderer.com/facade-configurator

BALCONIES AND PARAPETS

COHERENT DESIGN SEAMLESS IN EVERY DETAIL.

Another area of application for Duropal XTerior compact panels is balconies and parapets. Especially in multi-storey residential buildings, they enable balconies to blend perfectly into the appearance of the building – or to be highlighted as contrasting elements on request. In either case, the overall design benefits from the consistent appearance of the unique Exterior Matt texture.



Discover all the possibilities now –
with the Pfleiderer façade configurator.
Simply try it out online:
[pfleiderer.com/facade-configurator](https://www.pfleiderer.com/facade-configurator)

REFERENCES



© christoph meinschafer Fotografie



© Projeiter Leisner Fotografie



© christoph meinschafer Fotografie

INSTALLATION

Tangible support during installation

We have prepared the most important information about preparatory work and installation in our exploratory films. Pfleiderer provides detailed installation instructions that are available to download. As well as the information relating to building law about general design approval, they also contain manufacturer's recommendations for tools and fixing materials.



Explanatory films: storage, cutting and installation

pfleiderer.com/global-en/service/digital-services/assembly-videos-facade/assembly-videos-xterior-compact



Installation recommendation

pfleiderer.com/montageempfehlung-duropal-xterior-compact

Systematically installed to create the perfect result

Rear-ventilated curtain façades with Duropal XTerior compact / Duropal XTerior compact F panels can be adapted flexibly to the conditions and aesthetic requirements on site. They can be utilised on either aluminium or wood substructures.

SUBSTRUCTURES

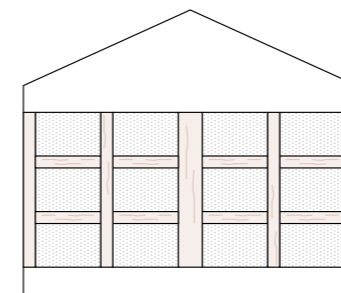

wood

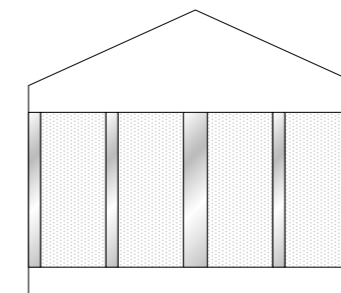

aluminum

FIXING MATERIALS

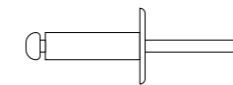

rivets

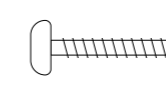

wood screws

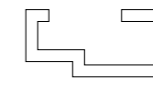

clasp system – TUF-S

PRODUCT INFORMATION

© christoph meinschafer Fotografie

DECORATIVE PANELS LACQUERED BOARDS

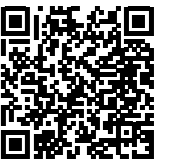

Duropol XTerior compact



Compact high-pressure laminate for outdoor use in standard quality according to EN 438-6:EDS / intensive decors according to EN 438-6:EGS. With uniform black-coloured core and single-sided decorative acrylic lacquer on the top side and decorative melamine resin surface on the reverse or double-sided decorative acrylic lacquer.

AREAS OF APPLICATION



Duropol XTerior compact fulfils the highest UV resistance requirements for the surface and due to its high mechanical strength values and design freedom, it is suitable for outdoor use, e.g. as facade, garden furniture, privacy screens, roof undersides, balconies or playground equipment. Especially if high standards of robustness, weather resistance and easy cleaning are required.

PRODUCT FEATURES



Product standard	EN 438-6
Reaction to fire	Normally flammable D-s2,d0 (EN 13501-1, CWFT acc. to 2003/593/EG)
EC scope	EN 438-7:2005 Compact laminate panels/sidings for exterior wall and ceiling finishes (including suspended ceilings)
Formaldehyde emission class	E1 E05
Density	Min. 1,350 kg/m ³ (EN ISO 1183-1)
Note	FSC certification or PEFC certification available on request.

FORMAT IN MM

Length	Width	Thickness
2,800	2,070	6 8 10 12 13





Duropol XTerior compact F – single-sided lacquering



Compact high-pressure laminate for outdoor use in flame retardant quality according to EN 438-6:EDF / intensive decors according to EN 438-6:EGF. With uniform black-coloured core and single-sided decorative acrylic lacquer on the top side and decorative melamine resin surface on the reverse.

AREAS OF APPLICATION

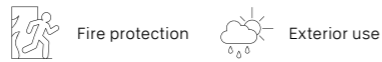

Duropol XTerior compact F fulfils the highest UV resistance requirements for the surface and due to its preventive fire protection, the high mechanical strength values and design freedom it is suitable for outdoor use, e.g. as facade, garden furniture, privacy screens, roof undersides, balconies or playground equipment. Especially if high standards of robustness, weather resistance and easy cleaning are required.

PRODUCT FEATURES

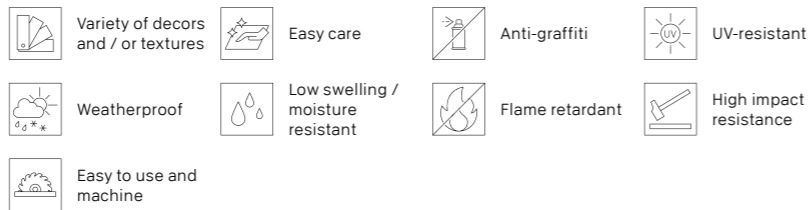

Product standard	EN 438-6
Reaction to fire	Flame retardant B-s1,d0 (EN 13501-1)
EC scope	EN 438-7:2005 Compact laminate panels/sidings for exterior wall and ceiling finishes (including suspended ceilings)
Formaldehyde emission class	E1 E05
Density	Min. 1,350 kg/m ³ (EN ISO 1183-1)
Note	FSC certification or PEFC certification available on request.

FORMAT IN MM

Length	Width	Thickness
2,800	2,070	8 10 12 13





**MADE IN
GERMANY**

PRECISION AS A PRINCIPLE: **MADE IN GERMANY**

Pfleiderer is addressing the challenge of manufacturing top-quality wood-based materials with its traditional, meticulous approach to doing business. With integrated quality, environmental, energy and safety management systems, a corporate culture that is based on its values and independent certification audits along the entire value creation chain. With environmental management systems that are certified according to ISO EN 14001 and ISO 50001, certifications according to FSC® (license code: FSC® C011773) and PEFC (license code: PEFC/04-32-0828), and also as a member of Qualitäts-gemeinschaft Holzwerkstoffe, the German association of high-quality wood-based material manufacturers, we illustrate how much we value transparency for our customers and partners.



MADE IN GERMANY

PIONEERING DETERMINATION **A BRAND WITH TRADITION**

Pfleiderer sets new standards when it comes to high-quality engineered wood materials with a particular focus on decorative products for furniture and interior design, exterior uses and proven structural wood construction solutions. Over 125 years of experience with the renewable wood material and a corporate philosophy that focuses strictly on sustainability make us the first choice for all trades, retailers, architects and planners who are looking for reliable solutions with groundbreaking added functional values to realise their ideas. As a German Standards "Brand of the Century" company, our standards and our commitment to quality and customer-orientation are particularly important to us.

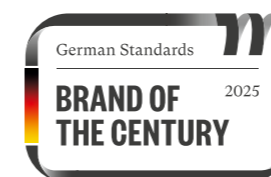

SUSTAIN- ABILITY



WE ARE COMMITTED TO THE UNITED NATIONS GLOBAL COMPACT

Those who rely on wood as a raw material rightly expect an environmentally conscious “green” material. At Pflöiderer we want to do full justice, to this to commodity, therefore been offering an extensive range of low-emission and environmentally friendly products for many years. Sustainability – in addition to ecological, social and economic aspects – as well as the careful use of natural resources are permanent pillars of our corporate philosophy. Consistent circular economy and wood recycling at the highest technological level as well as independent evaluation of our procurement, production and logistics processes ensure that we optimally harmonise qualitative our ecological requirements ensuring that we offer our customers the best possible service, manufacturing and logistics processes as well as a corporate culture of accountability. We ensure that you can use our products with a clear conscience and recommend them to your customers.

CORPORATE LEVEL



PRODUCT LEVEL

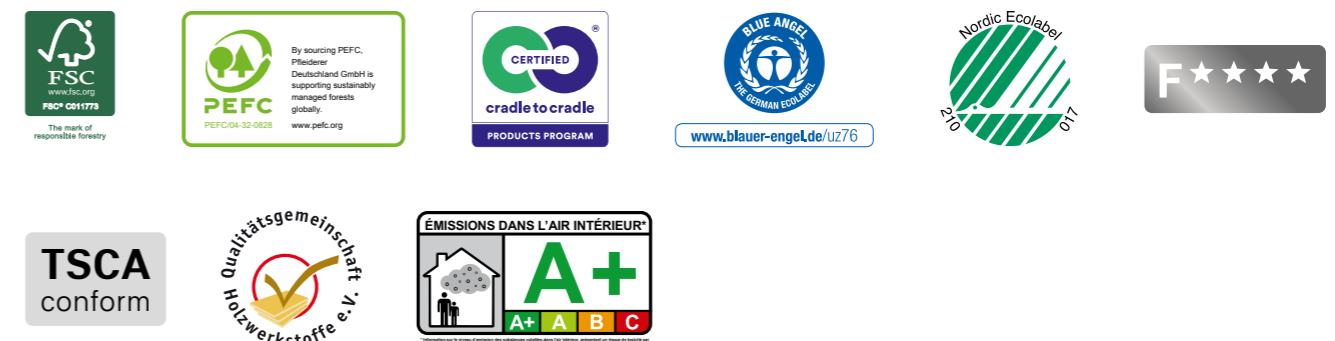

BUILDING CERTIFICATES



Learn more about our sustainability strategy:
pflöiderer.com/sustainability

SERVICE

STRONGER TOGETHER: FROM THE IDEA TO THE RESULT

Considered products provide the basis for us. However we support our partners far beyond that. Providing tailor-made solutions, making it easy for you to find the exact solution to meet your needs.

APPLICATION BROCHURES



Kitchen
pfleiderer.com/kitchen



Doors
pfleiderer.com/doors



Hospitality & Catering
pfleiderer.com/hotel-hospitality



Shop & Exhibition
pfleiderer.com/shop-exhibition



Facade
pfleiderer.com/facades-parapets



Health & Care
pfleiderer.com/healthcare



Home & Living
pfleiderer.com/home-living



Office & Education
pfleiderer.com/office-education



Timber Construction
pfleiderer.com/timber-construction



Travel & Transport
pfleiderer.com/travel-transport

DIGITAL TOOLS



WorkApp
workapp.pfleiderer.com
The quickest way to find the answers to all your decor-related questions.



Digital Product Finder
productfinder.pfleiderer.com
Use the digital productfinder to find the perfect material for your application in just a few steps.



Façade Configurator
pfleiderer.com/facade-configurator
To get to know the design options with our Duopal XTerior compact panels in more detail, we offer a façade configurator.



Room Designer
roomdesigner.pfleiderer.com
Combine all the decor collections in 26 different digital room layouts.



Eco Product Insights
pfleiderer.com/eco-product-insights
100 % transparent sustainability: all information on certificates, emission classes and recycled wood content is available at a glance.



Moodboard Tool
moods.pfleiderer.com
Choose colours from any image you like, and receive suggestions for matching decors from our portfolio.



3D-Viewer
3d-viewer.pfleiderer.com
View our surface textures from all sides and in different lighting conditions in a true to life 360-degree visualisation to judge their effect.



BIM-Data
pfleiderer.com/bim
Simply transfer product information, decor and texture images into your digital project planning.



Declarations of performance
pfleiderer.com/declarations-of-performance
In this area, you'll find a digital version of all relevant declarations of performance.

sales@pfleiderer.com



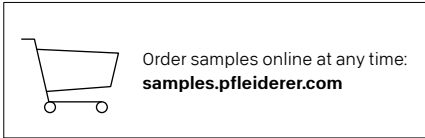

Decor Scanner
workapp.pfleiderer.com



© Copyright 2025 Pfleiderer Deutschland GmbH.

This information is issued with great care. We do not however accept any responsibility for the accuracy, completeness and timeliness. There may be slight colour differences between the printed brochure image and the actual design.

Due to the continuous development and modification of our products, possible changes to the relevant standards, laws and regulations, our technical data sheets and product documents expressly do not represent a legally binding guarantee of the properties specified therein. In particular, no suitability for a specific purpose can be derived from this information. It is therefore the personal responsibility of the individual user to check the processing and suitability of the products described in this document for the intended use and to take into account the legal framework and the current state of the art. Furthermore, we expressly refer to the validity of our general terms and conditions.

You can find our general terms and conditions on our webpage: www.pfleiderer.com



MADE IN GERMANY

Good to know: the Pfleiderer quality promise.

Pfleiderer wood-based panels stand for quality without compromise. We use sustainable raw materials and state-of-the-art production processes and we are fully committed to our site in Germany. For more information, visit quality.pfleiderer.com.

Pfleiderer UK Limited · Greenway House · Larkwood Way · Tytherington Business Park · Macclesfield · Cheshire SK10 2XR · England
Tel.: +44 (0) 16 25 660 410 · info-uk@pfleiderer.com · www.pfleiderer.com

Pfleiderer Deutschland GmbH · Ingolstädter Straße 51 · 92318 Neumarkt · Germany
Tel.: +49 (0) 91 81 / 28 480 · Fax: +49 (0) 91 81 / 28 482 · info@pfleiderer.com · www.pfleiderer.com